

easy-sew Drawstring Bag



What you need:

- .35m fabric (cotton, netting, or mesh)
- .75m cord

Bag sizes:

- SM approx 6 x 9" (15 x 23cm)
- MED approx 9 x 12" (23 x 30cm)
- LG approx 12 x 15" (30 x 38cm)

What you do:

1. Add 1" (2.5cm) to the width and 2" (5cm) to the height of bag dimensions. For the large size bag cut 2 pieces 13" (33cm) x 17" (43cm).

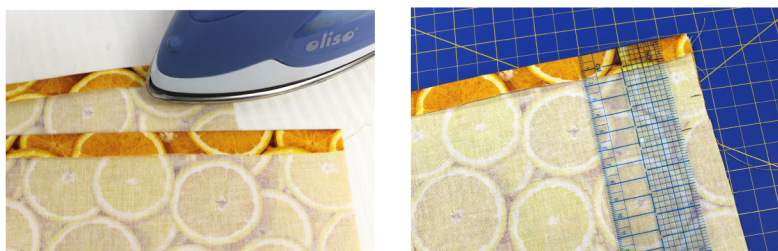

2. Fold the top edge of each piece down 1/2" (1.25cm) and press.
3. Pin the 2 pieces right sides together. Mark 1.5" (3.75cm) from the top edges and stitch around sides and bottom between markings. Zigzag stitch or serge sewn edges to prevent fraying.

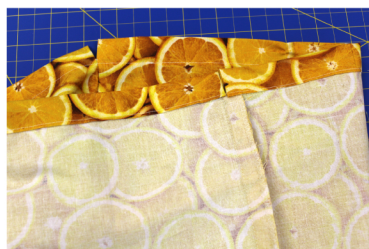

4. Clip seam at markings and press open. Fold top down 1" (2.5cm) and topstitch along the bottom folded edge to create the cord casing.
5. Using a safety pin, thread the cord through the casings and knot both ends together to secure.

Optional:

Add cord stoppers to keep the bag tightly closed.

